

PORTAL IV - 1º A

	PORTAL IV								PORTAL III						
	A	B	C	D	E	F	G	H	A	B	C	D	E	F	
5º - Ático	3d	3d	3d	3d	1d	/	/	/	3d	3d	3d	3d	2d	/	/
4º	3d	3d	3d	4d	2d	3d	3d	1d	3d	3d	3d	2d	3d	3d	2d
3º	3d	3d	3d	4d	2d	3d	3d	1d	3d	3d	3d	2d	3d	3d	2d
2º	3d	3d	3d	4d	2d	3d	3d	1d	3d	3d	3d	2d	3d	3d	2d
1º	3d	3d	3d	4d	2d	3d	3d	1d	3d	3d	3d	2d	3d	3d	2d
Baja	1d	3d	3d	3d	3d	3d	3d	1d	3d	1d	3d	3d	3d	3d	2d

Sup. Útil Interior Vivienda	74.10 m ² u
Sup. Construida (Incl. pp/ ZZ.CC.)	99.40 m ² c
Sup. Construida Exterior	11.85 m ² c

Superficies aproximadas.

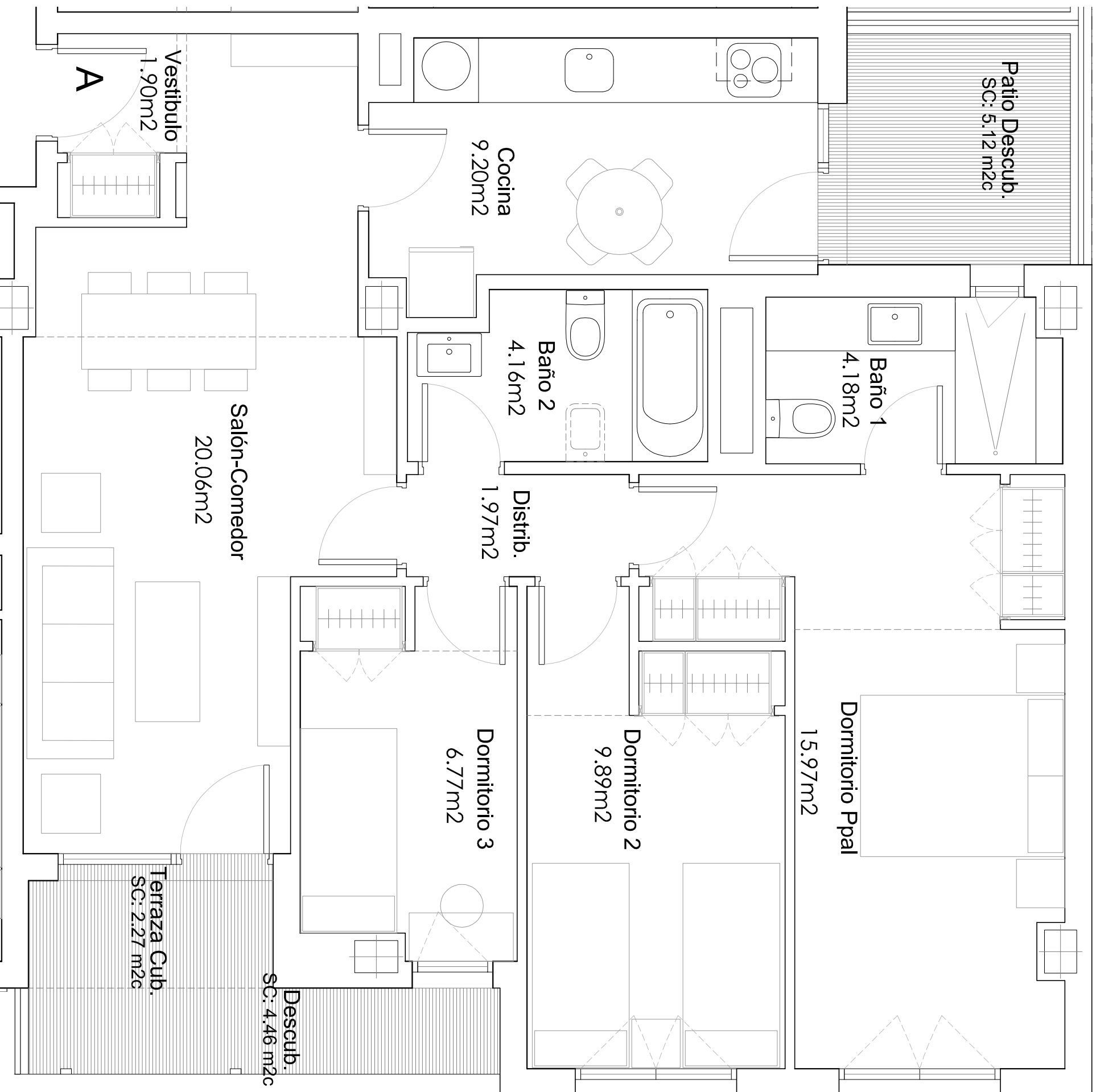
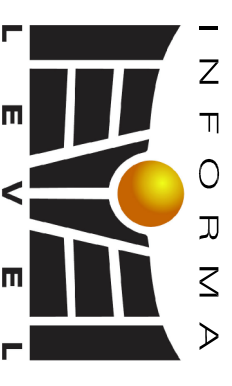
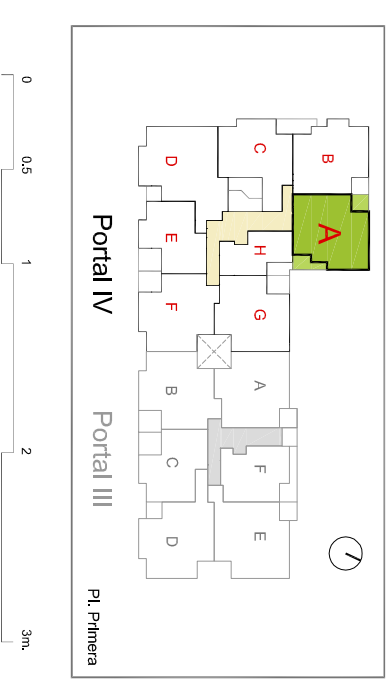

Superficies según Decreto 218 / 2005

Sup. Útil Total	79.50 m ² u
Sup. Construida Total (Incl. pp / ZZ.CC.)	103.05 m ² c