

PORTAL I - 1ºH

	PORTAL I								PORTAL II						
	A	B	C	D	E	F	G	H	A	B	C	D	E	F	
5º - Ático	3d	3d	3d	3d	3d	1d	/	/	3d	3d	3d	3d	2d	/	/
4º	3d	3d	3d	4d	2d	3d	3d	1d	3d	3d	2d	3d	3d	2d	/
3º	3d	3d	3d	4d	2d	3d	3d	1d	3d	3d	2d	3d	3d	2d	/
2º	3d	3d	3d	4d	2d	3d	3d	1d	3d	3d	2d	3d	3d	2d	/
1º	3d	3d	3d	4d	2d	3d	3d	1d	3d	3d	2d	3d	3d	2d	/
Baja	1d	3d	/	/	/	/	/	/	3d	1d	3d	/	/	/	/

Sup. Útil Interior Vivienda	38.55 m ² u
Sup. Construida (Incl. p/p ZZ.CC.)	53.30 m ² c
Sup. Construida Exterior	5.75 m ² c

Superficies aproximadas.

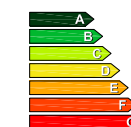
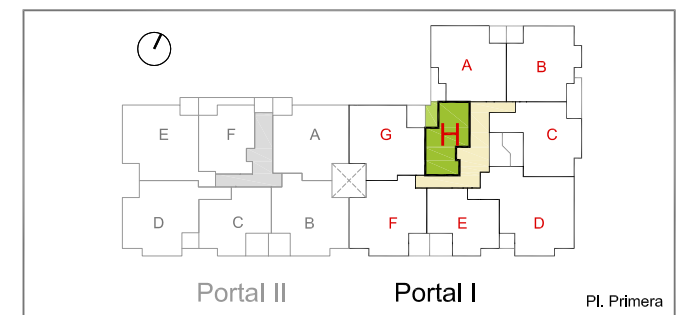

CALIFICACIÓN ENERGÉTICA
DE PROYECTO
EN PROCESO



Superficies según Decreto 218 / 2005

Sup. Útil Total	41.30 m ² u
Sup. Construida Total (Incl. pp / ZZ.CC.)	52.70 m ² c